



ZA215AP

kW 0.69 Hm 21 max
Hp 0.954 L/1' 137 max



Corpo Pompa Pump Body Pumpengehäuse	PP30 FV / PPO 20 V
Girante Chiusa Closed Impeller Geschl. Laufrad	PPO 30GF
Albero Motore Motor Shaft Motorwelle	AISI 416
Tenuta Meccanica Mechanical Seal Gleitringdichtung	GRAFITE/CERAMICA CARBON/CERAMIC KOHLE/KERAMIK

1~ 230V / 50Hz art. n.

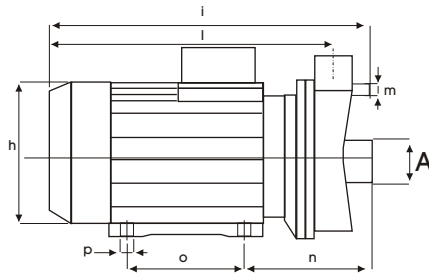
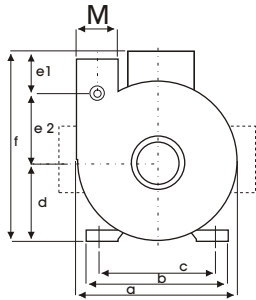

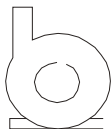
SX	A	M
 F3:	1"	1"

mod	a	b	c	d	e1	e2	f	g	h	i	l	m	n	o	p	kg
ZFP215AP	160	113	90	77	40	61	179	-	142	268	233	13	100	90	8	6,7

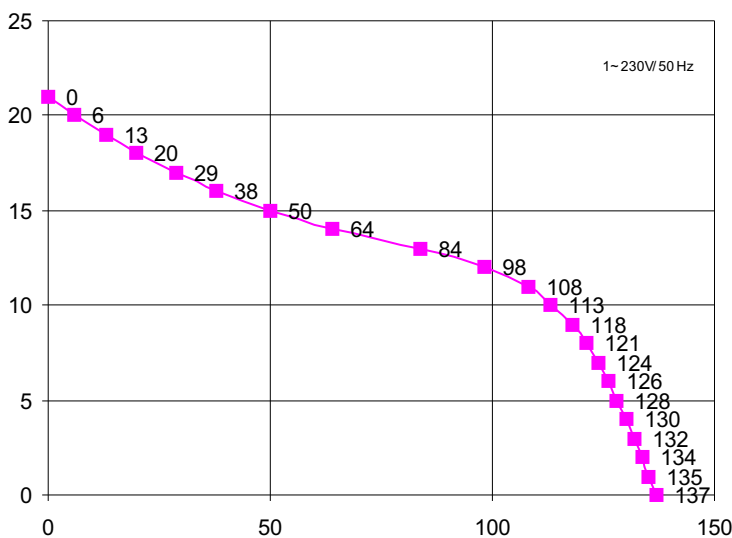

Hm	0	3	5	7	9	11	13	15	20	21
L / 1'	137	132	128	124	118	108	84	50	6	0

Potenza motore Motor power Motor Leistung	Hp 0,93 kW 0,69
Tensione/Frequenza Tension/Frequency Spannung/Frequenz	1~V/Hz 230/50
Corrente assorbita Power consumption Stromaufnahme	A 3,28
GPM RPM UPM	2800
Condensatore Capacitor Kondensator	16 µF
Protezione termica Thermal Overload Überlastschutz	155 °C
Classe isolamento Insulation class Isolationsklasse	F
Grado protezione Protection class Schutzklasse	IP X5
Servizio Duty Betriebsart	S1 CONTINUO CONTINUOUS DAUERBETRIEB

REVISIONE N. 04/02/04 P.01/039

Ci riserviamo il diritto di apportare modifiche tecniche.
We reserve the right of technical modifications.
Technische Änderungen vorbehalten.